

**ITEM 39. TRAFFIC TREATMENT – STREETScape IMPROVEMENTS –
KELLETT STREET POTTS POINT**

TRIM RECORD NO: 2017/007824

RECOMMENDATION

It is recommended that the Committee endorse footpath widenings in Kellett Street, Potts Point, north of Bayswater Road.

VOTING MEMBERS FOR THIS ITEM

<i>Voting Members</i>	<i>Support</i>	<i>Object</i>
City of Sydney		
Roads and Maritime Services		
NSW Police – Kings Cross LAC		
Representative for the Member for Sydney		

DECISION

BACKGROUND

As part of the City's commitment to calm traffic and improve residential amenity, it is proposed to widen the footpath of Kellett Street, Potts Point, north of Bayswater Road.

COMMENTS

Kellett Street at Bayswater Road is approximately 10 metres wide, providing one northbound traffic lane and two kerbside parking lanes.

Widening the footpath will help improve general safety in the area as part of the City's commitment to calm traffic and improve residential amenity. The proposal will reduce the distance pedestrians need to cross the road and reduce vehicles speeds adjacent to the intersection.

There will be no loss to kerbside parking spaces as part of the proposal and the treatment will not affect traffic flow.

CONSULTATION

The City consulted local residents and businesses in the area. There were 418 letters sent out with no responses supporting or opposing the proposal.

FINANCIAL





Appropriate funding for the proposal will be secured once greater certainty on the construction timeline is reached.

ATTACHMENTS

Traffic Treatment – Streetscape Improvement – Kellett Street Potts Point

Clement Lim, Senior Traffic Engineer

LEGEND

-  CONCRETE PAVING WITH IMPRINT PATTERN TO MATCH EXISTING
-  GRANITE PAVING
-  PLANTED GARDEN PLANTING BY OTHERS
-  SURFACE ROAD RESTORATION PAVEMENT
-  FULL DEPTH ROAD RESTORATION PAVEMENT - NEW ROAD DEPTHS AND MATERIALS TO MATCH EXISTING BAYSWATER RD FLEXIBLE PAVEMENT

WORKS PLAN

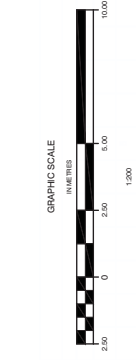
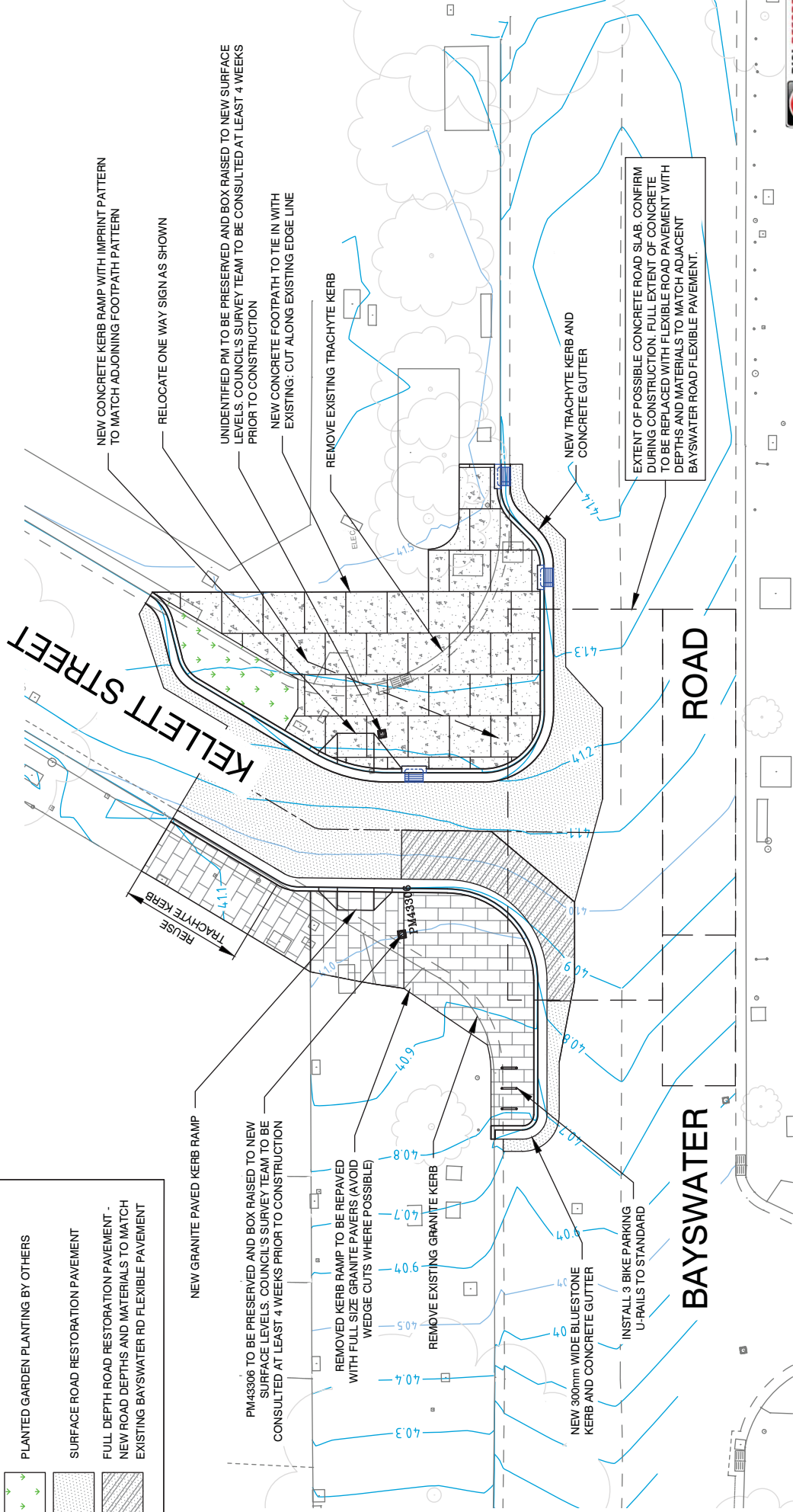

5				Project:	KELLETT STREET POTTS POINT
4				Design released and issued for QUOTATION	JN
3	13/01/2017	AS		Design released and issued for QUOTATION	JN
2	22/02/2016	AS		Issued for QUOTATION	JN
1	15/09/2016	AS		Issued for review	JN
Date	No.	By	Amendments	Checked:	AS
				Approved:	JN
				Scale:	1:200
				Drawn:	AS
				Approved:	JN
				Sheet No.	2 OF 7
				Drawing No.	E3-16/1469
				CAMS Job No.	10155696
				ISSUED FOR QUOTATION NOT TO BE USED FOR CONSTRUCTION	3
				Issue	